



**GAMMA**  
HIGH VOLTAGE

# HVD 500/60 With Base

## FEATURES:

- High Input Impedance
- High Accuracy
- Corona-Free Operation

## DESCRIPTION:

The GAMMA Model HVD-500/60 offers laboratory and production facilities a superior solution for high voltage measurement, delivering an accuracy meeting or exceeding 0.2%. Designed to pair with standard digital voltmeters or differential voltmeters, this voltage divider is highly adaptable. Its 10000 megohm input impedance makes it perfect for measuring high voltage from low current sources that would typically overburden traditional impedance dividers. Equipped with a 30-inch toroidal high voltage bushing, the HVD-500 prevents corona-related leakage, ensuring the voltage divider ratio remains consistent up to 500kV.



## ELECTRICAL CHARACTERISTICS

|                    |                                 |
|--------------------|---------------------------------|
| Input Voltage:     | 500KV DC Maximum                |
| Input Impedance:   | 10000 MOhms                     |
| Output Impedance:  | 100 KOhms                       |
| Output Taps:       | 5V ( 1 Volt = 100 KV )          |
| Temp. Coefficient: | 75PPM ( 25PPM For "S" Version ) |
| Accuracy:          | 0.2%                            |
| Size:              | 60" Height, Max Width 30"       |
|                    | Input Termination 30" Toroid    |
| Output connector:  | BNC                             |

- \* Performance Dependent on Ambient Lab Conditions
- \* Use with High Impedance Data Acquisition System
- \* Contact Gamma For Customization
- \* Optional Base Shown

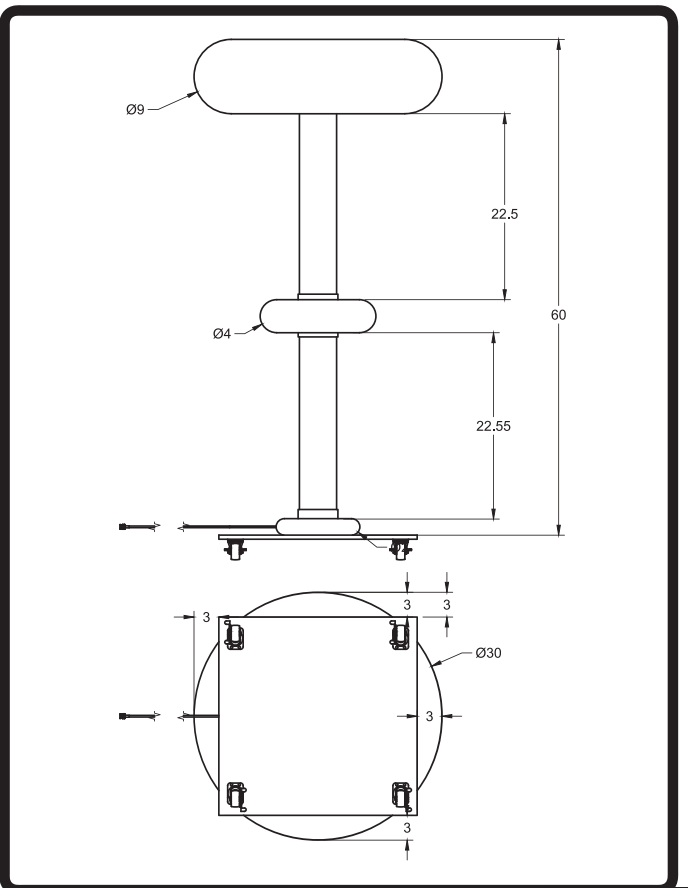

©2025 Gamma High Voltage Research

**Get in touch**

 386-677-7070

 [gammahighvoltage.com](http://gammahighvoltage.com)

 1096N US Highway 1, STE 109  
ORMOND BEACH, FL 32164